

Apartment 3 camere - 1004, parter, tronson 1

Str. George Ranetti, Nr. 2-8, Sector 6

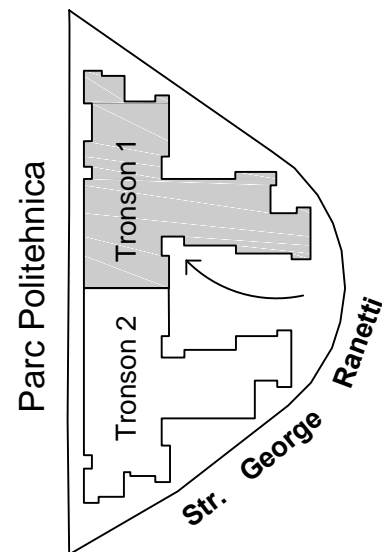

Total suprafata construita apartament = 132.80 mp, din care:
 - suprafata construita terasa = 31.00 mp
 - suprafata construita gradina = 24.60 mp
Total suprafata utila apartament = 90.90 mp

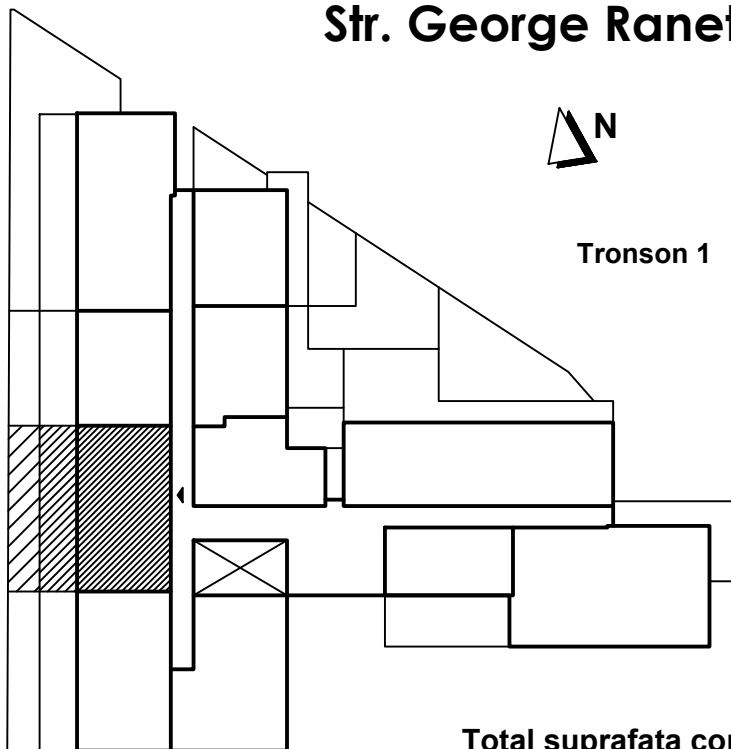